

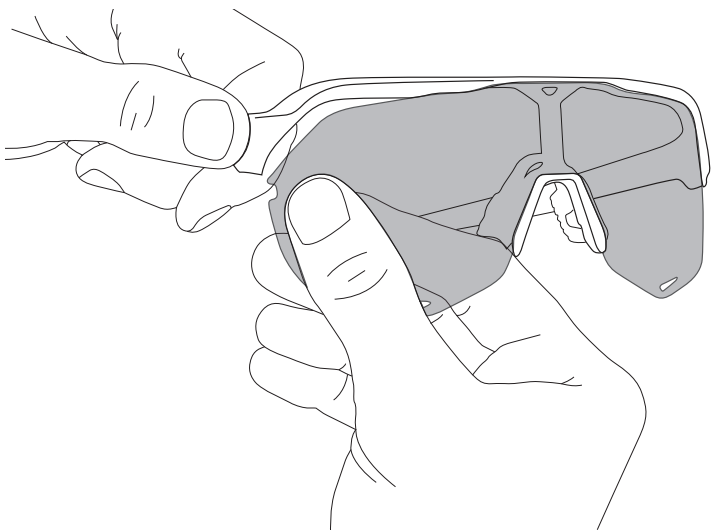

S2 LENS CHANGING INSTRUCTIONS

Lens Removal:

1. Hold one end of the lens. Gently pull apart to release the mounting tab from the frame. Repeat on the other end.



2. Hold the top frame in the center of the glasses with one hand while grasping the center of the lens near the nose area with the other hand. Gently pull apart to release the mounting tab from the frame.

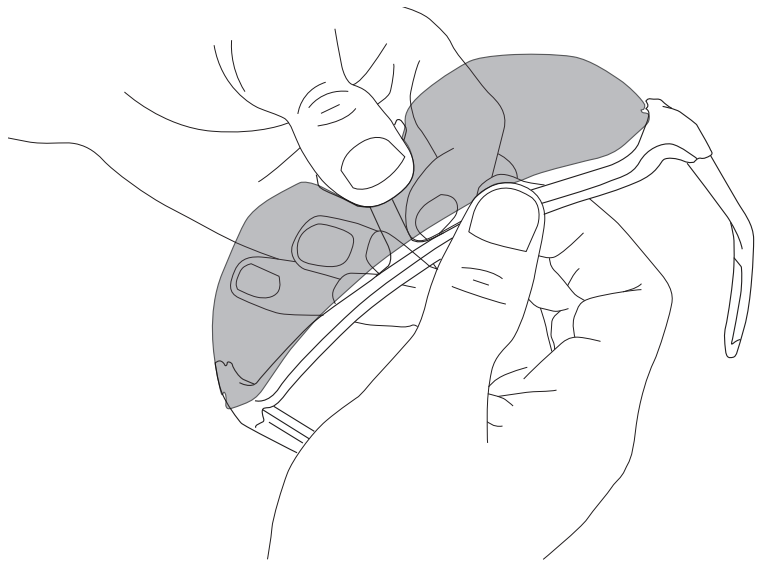

3. Once the lens is free from the top of the frame, it will easily release from the nose piece.

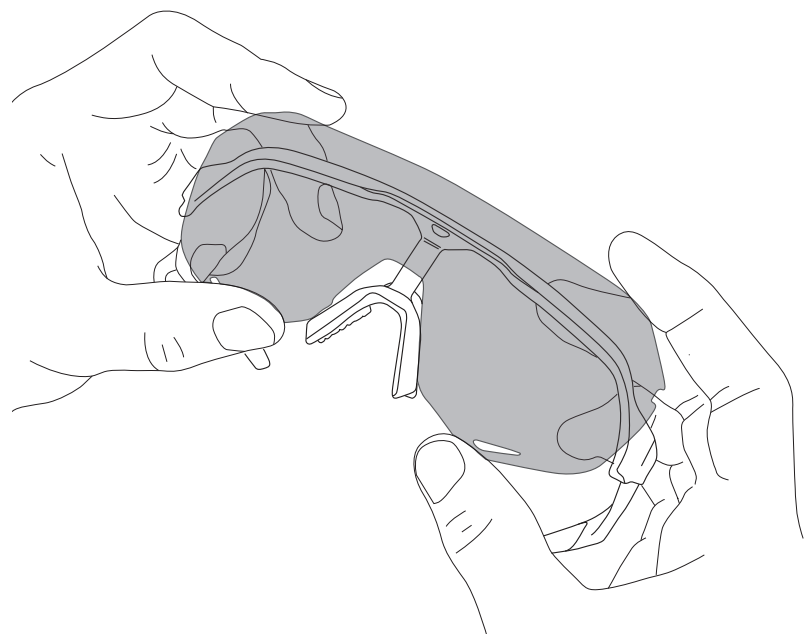

Lens Installation Steps:

1. Hold the nose area of the glasses frame with one hand and gently insert the lens into the lens channel of the frame at the nose area.

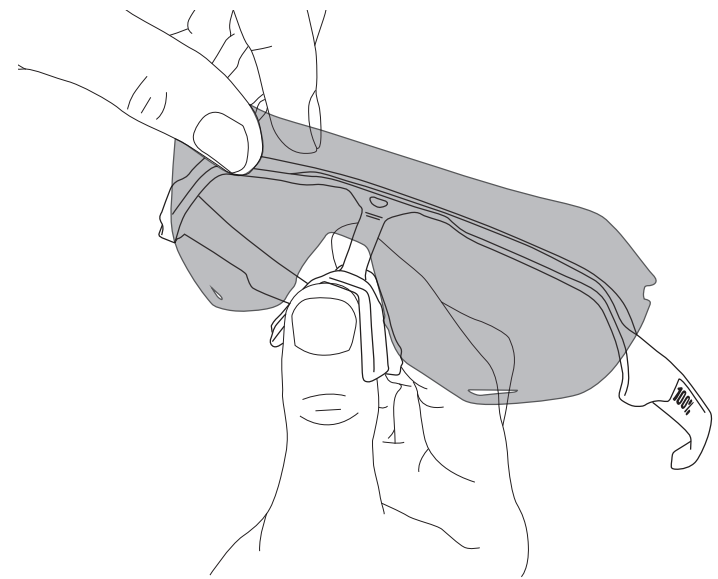

2. Gently apply pressure on the lens with your thumbs while applying slight pressure in the opposite direction with your finger on the frame. This will cause the remaining lens mounting tab to « pop » into place in the frame.

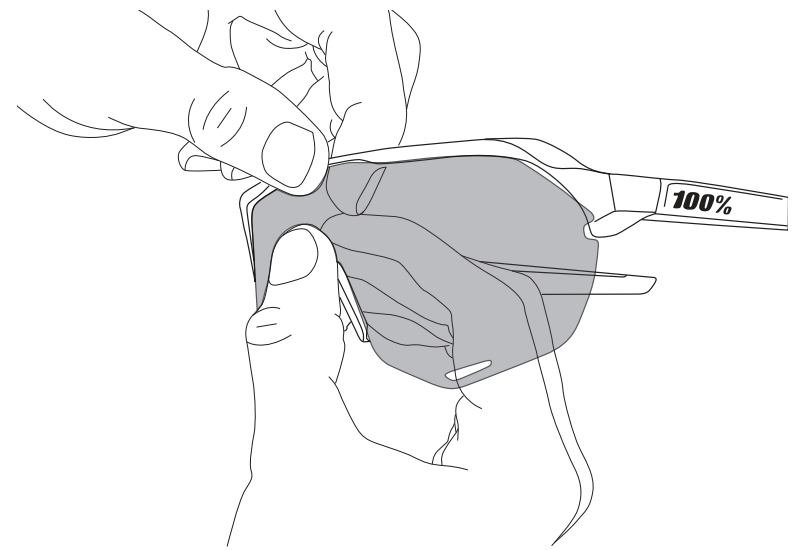

3. Gently insert the lens into one end by inserting the mounting tab into the frame. Repeat on the other end.

